

**Model: #43126E/#43127E/#43135E**  
**OWNER'S MANUAL**

**WARNING**

- **ATTENTION! NO PROTECTION AGAINST DROWNING!**
- **SWIMMERS ONLY!**
- Fully inflate all air chambers.
- This is not a life-saving device. Do not leave children unattended while device is in use. Competent adult supervision should always be provided.
- Keep away from flames and fires.
- Before every use, carefully inspect all product components to ensure everything is in good condition and tightly secured. Please stop and make repairs if you find any damage.
- Be careful when placing product on the ground. Sharp and rough objects such as rocks, cement, shells, glass, etc. may puncture the product.
- Don't leave the product exposed to sun for long periods of time. Otherwise, the product material is likely to stretch and/or change shape. This can cause irreparable damage.
- Never leave in or near the water when not in use.
- Never use in stormy weather, or in rough conditions. Seek shelter when lightning is present, **DO NOT** stay on the product.
- Distribute persons or loads evenly. Uneven distribution of persons or loads may result in tipping and drowning.
- Use in calm shallow waters near the shoreline.
- Never allow diving to or from this product.
- Do not use for navigational purposes such as a boat. This is not a boat.
- Do not tow product with a boat.
- Know and follow local water safety rules and regulations.

**SAVE THESE INSTRUCTIONS**

**Note: Do not over inflate. Do not use an air compressor or compressed air.**

**Note: Never stand on or rest object on the product during inflation.**

**Note: Always check product for leaks before use.**

**ASSEMBLY**

1. Take the island and accessories out with care. Spread the island out.
2. Open the 3-interconnecting valves and inflate (the air pump is not included). Close the valves after inflation and press them into the air chambers.
3. Thread the rope through the grommets around the outside of the island one by one. (Only for 43126E)
4. Connect the climb-up cushion to the island using the ropes and knot the ropes to make the climb-up cushion secure. (Only for 43127E)
5. Put the cooler bag inside its holder in the island. (Only for 43126E)
6. Fill the anchor bag with rocks or sand to weigh it down. Hang the anchor bag to make the island more stable.

**DISASSEMBLY**

1. Remove all accessories from the island.
2. Pull out the stoppers of the 3-interconnecting valves to deflate.

**REPAIR**

1. If the product is damaged, use the provided repair patch.
2. Clean the area to be repaired.
3. Carefully peel the patch and remove it from the backing.
4. Press patch over the area to be repaired.
5. Wait 30 minutes before inflation.

**CLEANING AND STORING**

1. After deflation, use a damp cloth to gently clean all surfaces.

**Note:** Never use solvents or other chemicals that may damage the product.

2. Store in a cool, dry place, out of reach of children.
3. Check the product for damage at the beginning of each season and at regular intervals when in use.

Ref	Description	43126E	43127E	43135E
A	Island	1	1	1
B	Anchor bag	1	1	1
C	Rope	2	3	1
D	Cooler bag	2	-	-
E	Repair patch	1	1	1
F	Climb-up cushion	-	1	-

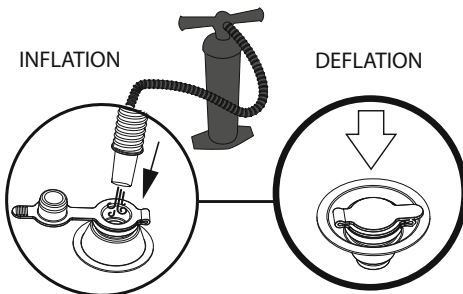
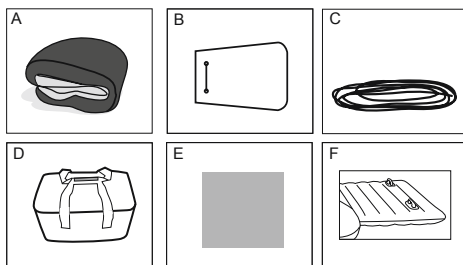



For support please visit us at:  
**[bestwaycorp.com/support](http://bestwaycorp.com/support)**

**©2019 Bestway Inflatables & Material Corp.**

All rights reserved/Tous droits réservés/Todos los derechos reservados/Alle Rechte vorbehalten/Tutti i diritti riservati

®™ Trademarks used in some countries under license to/

Marques ®™ utilisées dans certains pays sous la licence de/

Marcas comerciales ®™ utilizadas en algunos países bajo la licencia de/

®™ Die Warenzeichen werden in einigen Ländern verwendet unter Lizenz der/

®™ Marchi utilizzati in alcuni paesi concessi in licenza a

**Bestway Inflatables & Material Corp., No.3065 Cao An Road, Shanghai, 201812, China.**

Manufactured, distributed and represented in the European Union by/

Fabriqués, distribués et représentés dans l'Union Européenne par/Fabricado, distribuido y representado en la Unión Europea por/

Hergestellt, vertrieben und in der Europäischen Union vertreten von/Prodotto, distribuito e rappresentato nell'Unione Europea da

**Bestway (Europe) S.r.l., Via Resistenza, 5, 20098 San Giuliano Milanese (Milano), Italy**

Distributed in North America by/Distribués en Amérique du Nord par/Distribuido en Norteamérica por

**Bestway (USA) Inc., 3411 E. Harbour Drive, Phoenix, Arizona 85034, United States of America**

Tel: +86 21 6913 5183 (For U.S. and Canada)

Distributed in Latin America by/Distribués en Amérique latine par/Distribuido en Latinoamérica por/Distribuido na América Latina por

**Bestway Central & South America Ltda, Salar Ascotan 1282, Parque Enea, Pudahuel, Santiago, Chile**

Distributed in Australia & New Zealand by **Bestway Australia Pty Ltd, 98-104 Carnarvon Street, Silverwater, NSW 2128, Australia**

Tel: Australia: (+61) 29 0371 388; New Zealand: 0800 142 101

Exported by/Exporté par/Exportado por/Exportiert von/Esportato da

**Bestway (Hong Kong) International Ltd./Bestway Enterprise Company Limited**

Suite 713, 7/Floor, East Wing, Tsim Sha Tsui Centre, 66 Mody Road, Kowloon, Hong Kong

**[www.bestwaycorp.com](http://www.bestwaycorp.com)**

Made in China/Fabriqués en Chine/Fabricado en China/Hergestellt in China/Prodotto in Cina